

JCI-80GM 01&02 TYPE

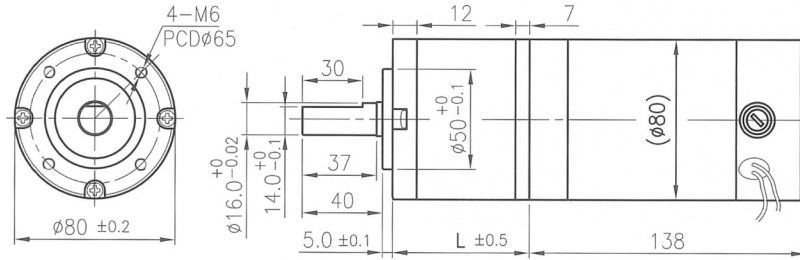

- 사용 습도(Operating relative humidity) : 20% ~ 85%
- 사용 온도(Operating temperature) : -10°C ~ +60°C

제품도면 (Dimension)



감속모터 사양 (Geared Motor Specification)

감속기 길이 (mm) Gear Head L		52.3	68.8				85.3				101.8										
감속비 Reduction ratio		1/4	1/13	1/15	1/19	1/21	1/49	1/55	1/71	1/80	1/103	1/117	1/186	1/210	1/306	1/393	1/445	1/571	1/647		
01 Type 12v	정격토크(kg-cm) Rated torque	7.6	22.4	25	32	36	73	82	105	120	125	125	125	125	125	125	125	125	125		
	정격 회전수(RPM) Rated speed	445	130	115	90	80	34	30	23.5	21	16.7	14.7	9.3	8.3	5.8	4.5	4.0	3.2	2.8		
02 Type 24v	정격토크(kg-cm) Rated torque	9.7	28.6	32	41	47	93	99	125	125	125	125	125	125	125	125	125	125	125		
	정격 회전수(RPM) Rated speed	470	140	124	95	85	36	32	25.5	23	17.8	15.6	9.9	8.8	6.0	4.7	4.2	3.3	2.9		

모터부 사양 (Install motor specification)

01Type Motor (DC 12v)

• 정격 토크 Rated torque	2,500	(gf-cm)
• 정격 회전수 Rated speed	1,700	(RPM)
• 정격 전류 Rated current	5,300	(mA)
• 무부하 회전수 No load speed	2,000	(RPM)
• 무부하 전류 No load current	1,100	(mA)
• 정격 출력 Rated output	43.6	(W)

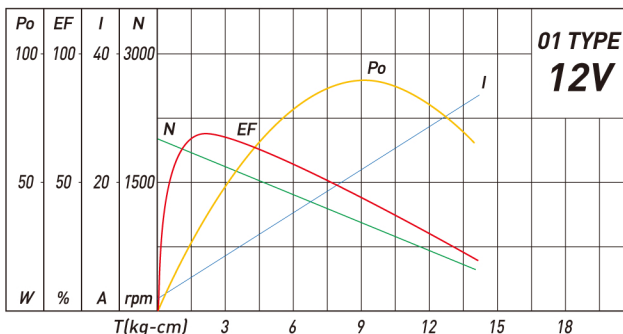

02Type Motor (DC 24v)

• 정격 토크 Rated torque	3,200	(gf-cm)
• 정격 회전수 Rated speed	1,800	(RPM)
• 정격 전류 Rated current	3,400	(mA)
• 무부하 회전수 No load speed	2,000	(RPM)
• 무부하 전류 No load current	600	(mA)
• 정격 출력 Rated output	59.0	(W)

